

RS3

Great for –mega concerts

Biggest roof system in our product range.
 Complete roof is based on TS3 towers (fork end connections) and 4GS-62 heavy duty truss system.
 Large covering area is suitable to all medium & big event stages.
 Cover is in keder profile to allow easy mounting and drying.
 Due to fork end connectors, there are no spigots needed and it save lot of time during assembling.

Technical data

max. dimension - stage size	>	20x14 m
max. outside dimension	>	24x16 m
max. clearance	>	12 m
max. height	>	14,8 m
max. load bearing capacity	>	9000 kg
total weight	>	7000 kg

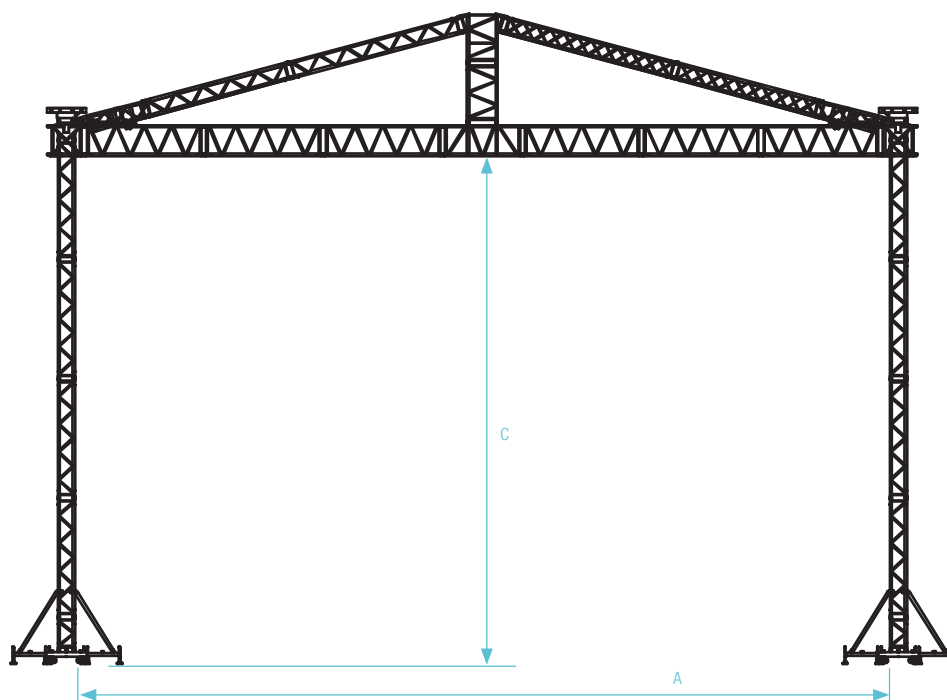
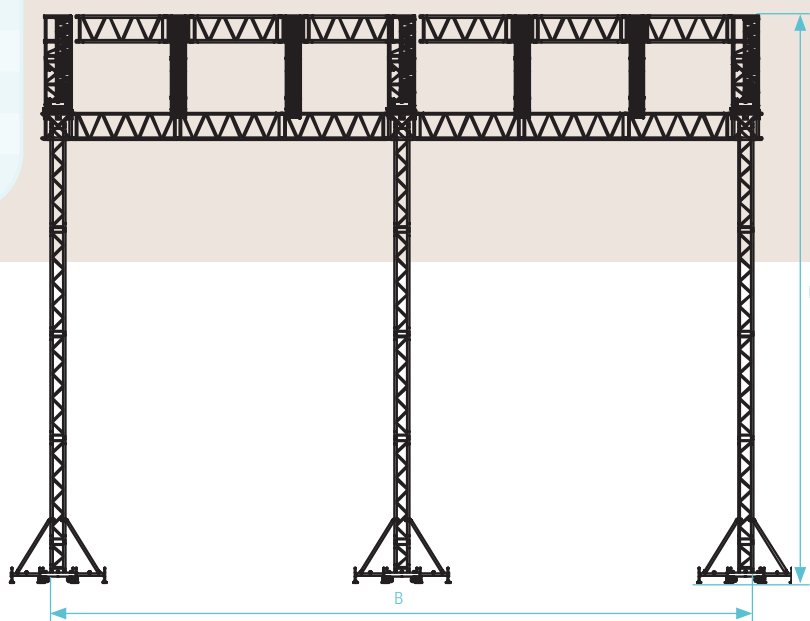

ROOF RS3

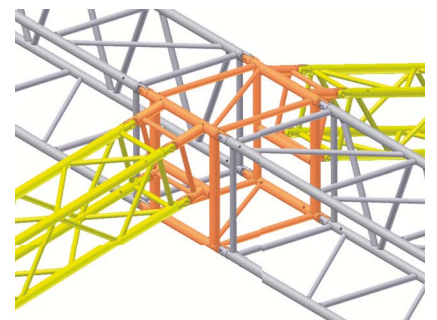
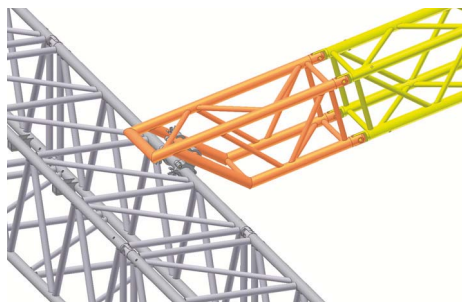
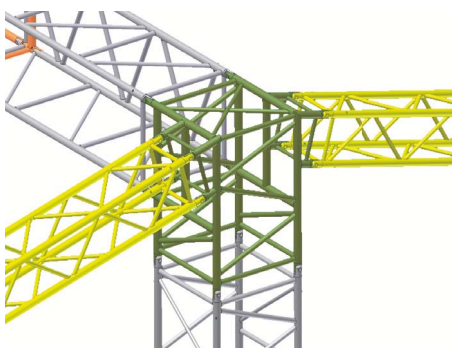
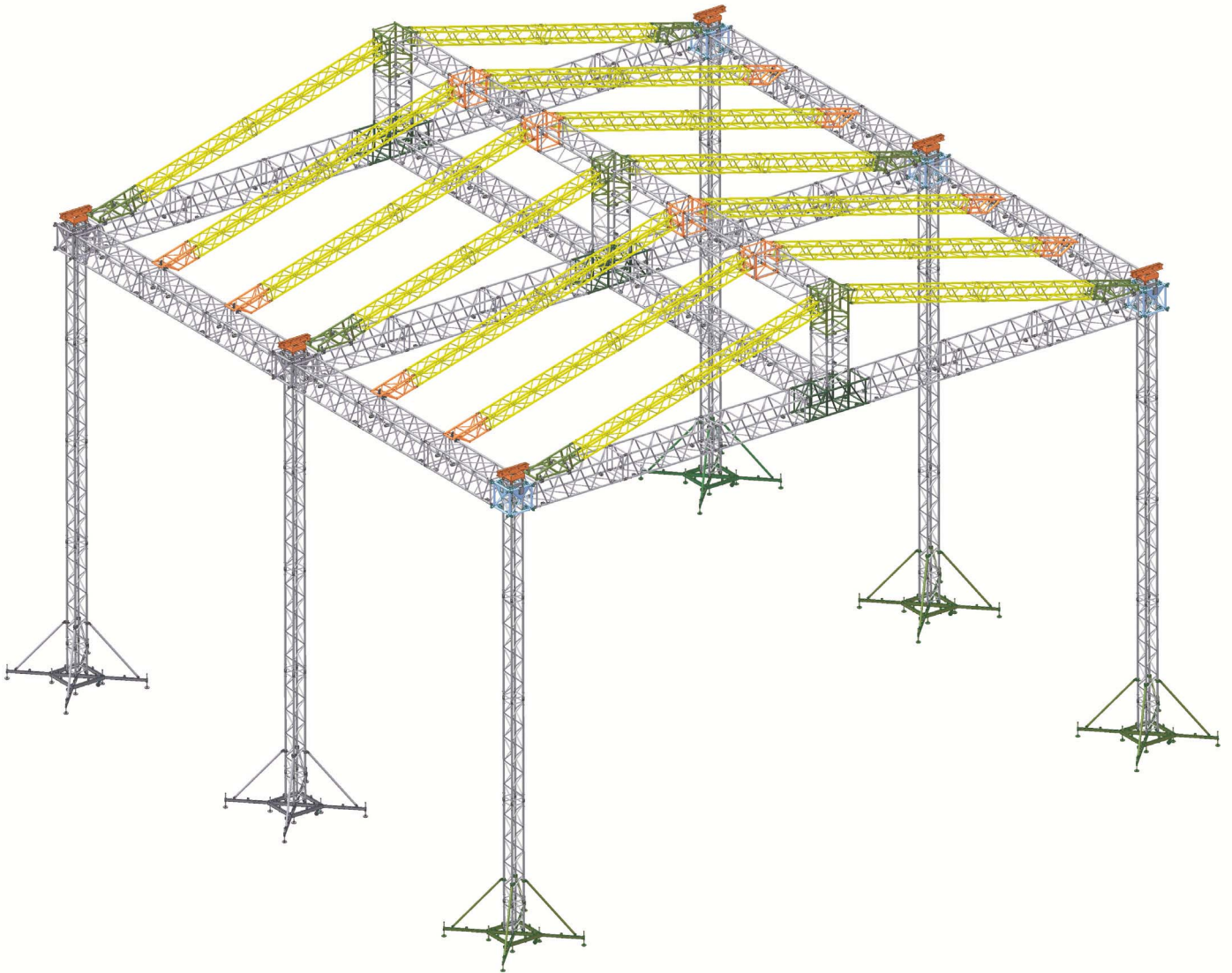

Roof size	A: Inside width	B: Inside depth	C: Clearance	D: Height
15x12 m	15,0 m	12,0 m	12,0 m	14,8 m
16x14 m	16,0 m	14,0 m	12,0 m	14,8 m
20x14 m	20,0 m	14,0 m	12,0 m	14,8 m